

Almy Pew Torches

Assembly and Installation

In order to minimize the effects of excess packaging and high delivery costs on the price of your torch, we have shipped it in easy-to-assemble parts. Follow these simple instructions to assemble and install your torch.

PEW TORCH PARTS

Each pew torch in this package includes these parts:

- A** Brass bobèche (wax catcher-candle holder), found inside the small box(es) in the interior of this package.
- B** Wood or brass pole — one end with a rubber “foot”, the other with a threaded hole to accept the bobèche (A). Also a sliding dovetail bracket is pre-installed approximately 13” from the foot of the pole.
- C** Brass bracket, either Permanent or Removable Style. The Permanent-style Bracket will include two brass wood screws. Brackets are inside the small boxes in the interior of this package.
- D OPTIONAL PARTS**
 - Glass globe/chimney, if a part of the torch you ordered.
 - Almy Liquid Candle™, if ordered with your torch.
 - Candle socket, if ordered with your torch.

TO ASSEMBLE PEW TORCHES

Screw Bobèche (A) to Pole (B) by turning Part A clockwise. Make snug — do not over tighten.

TO ADD OPTIONAL PARTS

1. Almy Liquid Candle. Screw candle onto fixed threaded stud in the bobèche.
2. Glass globe/chimney. Depending on torch style, fit glass chimney into ornamental fitting, or into holder with set screws. If fixture with set screws, do not over tighten as chimney is fragile.
3. Socket. Screw socket onto the fixed threaded stud in the bobèche.

TO INSTALL PEW TORCHES

PERMANENT BRACKET

1. Locate a flat, vertical surface near the top of pew back or pew end. Note the distance up from the floor you have chosen and use it for all installations so all torches will be at the same level. The bottom edge of the bracket must be positioned at least 13” above the floor.
2. Using illustration “Template”, mark the position of the screw holes.
3. Drill two holes, using a $\frac{3}{32}$ ” drill bit.
4. Screw Bracket to the pew. Note that one end of the dovetail section of the bracket is rounded. The rounded end should point up.
5. Slide torch pole into bracket and check height and plumb.

REMOVABLE BRACKET

1. Fit over the top of pew with torch holder on outside of pew and tightening knob on inside of pew. The bottom edge of the bracket must be positioned at least 13” above the floor.
2. Turn knob clockwise to tighten bracket on pew.
3. Slide torch pole into bracket and check height and plumb.



CM ALMY

800.225.2569 www.almy.com



Pew Torch Parts

A Bobèche/socket/ support with stud

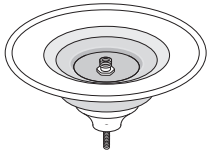

B Pole

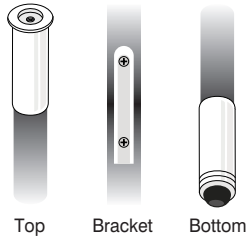

C Pew Bracket— Permanent

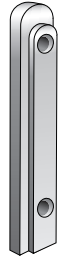

C Pew Bracket— Removable

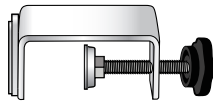

D OPTIONAL PARTS

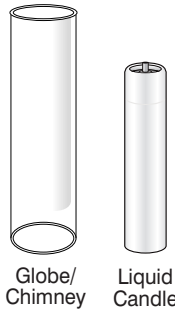

Globe/
Chimney

Liquid
Candle



Socket

Assemble Pew Torch

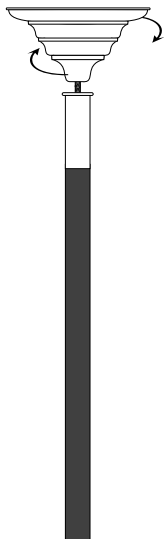

Adding Optional Parts

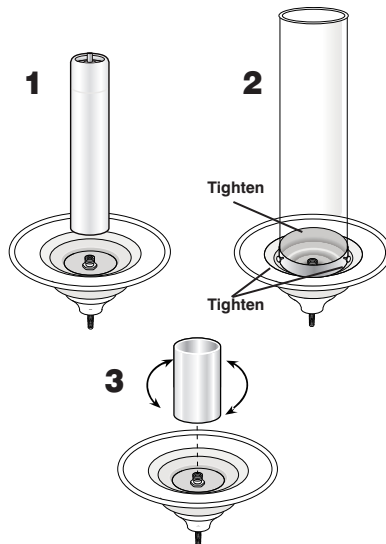

Install Permanent Pew Torch Bracket

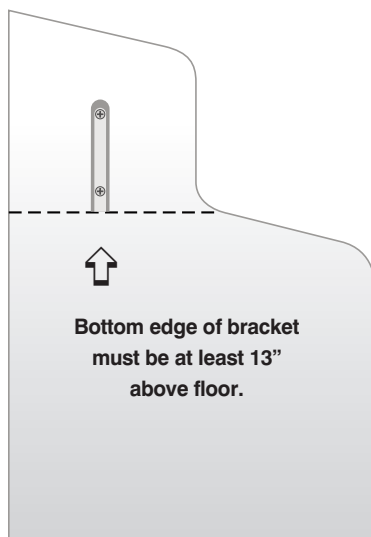

Bottom edge of bracket
must be at least 13”
above floor.



Use this as a template to
mark screw holes.